



Mitaka City's 60th Anniversary

MITAKA CITY NEWS



March 1, 2011 No. 136

Published monthly by:

Mitaka Municipal Office, Tokyo

Edited by:

Secretariat and Public Relations Section
Mitaka Municipal Office
1-1, Nozaki 1-chome, Mitaka, Tokyo
181-8555

Phone: 0422-45-1151

URL: <http://www.city.mitaka.tokyo.jp/english/index.html>

Town Development Base for Safety, Security, Health and Longevity

The city has been working on the improvement of the area around Mitaka Civic Center!

Many of Mitaka's public facilities, which have been actively improved to cope with the rapid population growth and urbanization that has occurred since Mitaka's municipalization in 1950, are approaching time for their renovation. We also desire to improve their aseismic capacity, barrier-free accessibility, and energy conservation. Mitaka City has promoted, on a priority basis, improving the aseismic capacity and/or rehabilitation of elementary and junior high schools, especially as they are public facilities used as evacuation sites in times of disaster. This priority is followed by the improvement project to rebuild and relocate the public facilities in the area around Mitaka Civic Center, which will be implemented as the main project for the "Urban renewal project" in the Third Mitaka Master Plan (the second revision).

The public facilities to be consolidated in this project currently face problems with aseismic capacity and/or deterioration, and prompt attention is required in order to improve safety for visitors. In drawing up plans, the city will aim to optimize facility size by maintaining or enlarging the size of current specialized-use areas while also reducing overall facility size (including common-use areas/public areas), and also aims to establish safety and security by relocating and consolidating some of the facilities.

Shinkawa disaster prevention park (tentative name) and multifunctional compound facilities

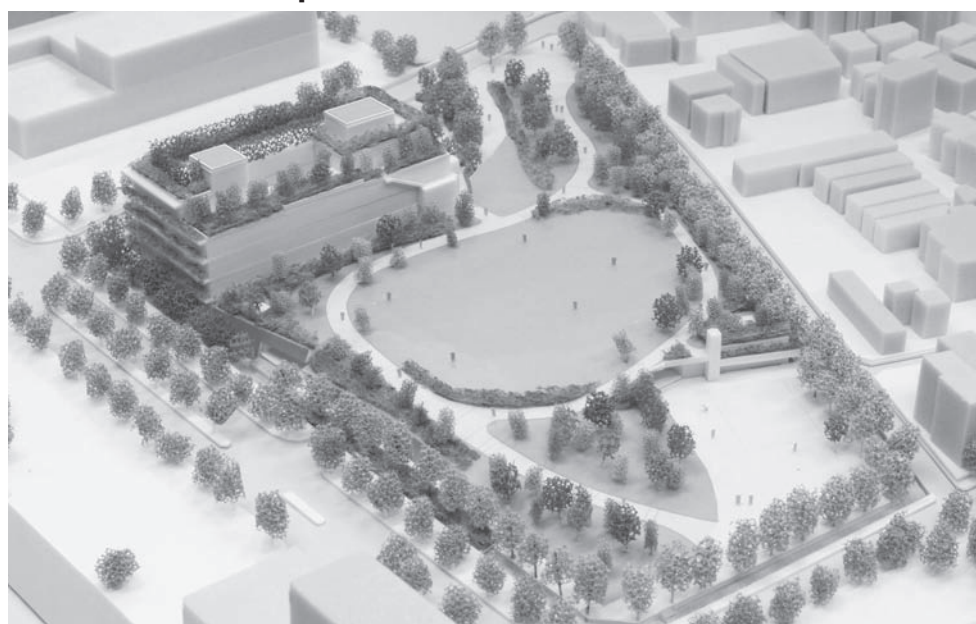

Image of the planned project for "the improvement of the area around Mitaka Civic Center" (This is an unfixed model created in the basic design phase)

<What is "the improvement of the area around Mitaka Civic Center"?>

This is the name of the main project of Mitaka's "Urban renewal project," detailed in the third Mitaka Master Plan (the second revision), to renew and/or relocate facilities which face problems in regards to aseismic capacity and/or deterioration. Building a disaster-prevention park on the old market site of Tokyo Tama Seika Co.,Ltd will secure a fixed temporary evacuation site and improve the disaster-prevention capacity of the area. It will become the emergency headquarters in times of disaster. Relocation and consolidation of deteriorating facilities or those without aseismic capacity will promote communication between different fields, and will also improve safe and secure services for citizens. The city will promote town development for health and longevity by building sports facilities in the disaster-prevention park instead of building the comprehensive sports center (tentative name), which was planned for construction in Iguchi.

<Project Schedule>

If all the procedures progress smoothly, the basic design will be completed in fiscal 2010, the implementation plan will be developed in fiscal 2011 and 2012, and finally construction will begin in fiscal 2013. The project will be completed after a few years of construction.

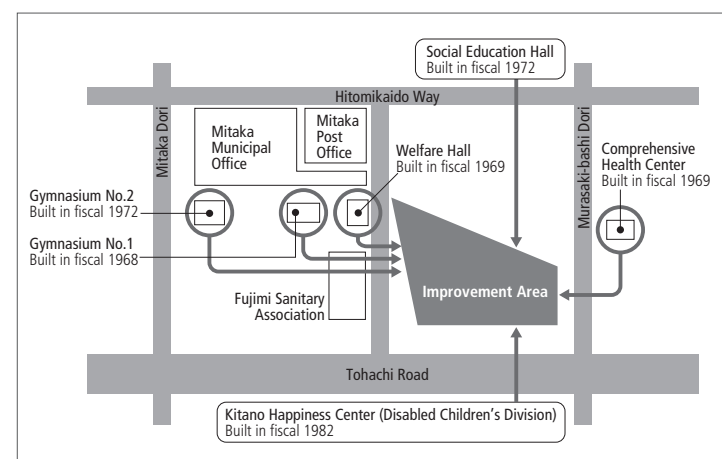

<Overview of the facilities>

◆Health and Sports Zone

1. Swimming pool

Depth-adjustable "moving floor" to enable children's use or walking exercises in the water.

2. Martial arts and sumo training hall

The training hall has two rooms each for judo and kendo, and a sumo training hall (previously an outdoor facility, we are considering to move it indoors). We will also consider multipurpose usage of the hall during off-hours.

* Western and Japanese archery grounds will not be included in the sports facilities, but will be allocated with parking lots and green spaces on the sites of the existing buildings (Gymnasiums No.1 and No.2, Welfare Hall, etc.) within the Civic Center.

3. Main and Sub Arenas

The main and sub arenas will have respectively 2.5 times and 1.3 times larger areas than the existing Gymnasium No.1. We will consider multiple usages by dividing the arenas with nets when needed.

4. Outdoor Areas and Park

A multi-purpose flat field for light exercises will be placed in the center of the park. It will also be developed as a temporary evacuation site with emergency toilet facilities in case of disaster.

◆Welfare and Lifelong learning Zone

5. Comprehensive Health Center

The building will be accessible by walking up a gentle slope from the park side or by using an elevator from the first floor. The center will be equipped with a waiting room, a resting room, and a kitchen to improve its convenience. Its function as the base of community healthcare services will remain unchanged.

6. Kitano Happiness Center (Disabled Children's Division)

The center will be the core facility for specialized support for child development with consultation, special education, training, etc. The center will be developed with privacy, security, and barrier-free accessibility in mind for children and parents to use with ease.

7. Social Education Hall

We expect more active utilization of the hall since it will be upgraded and expanded. In addition, the sports facilities which are currently included in the Social Education Hall will be transferred to the Health and Sports Zone.

8. Welfare Hall

The Welfare Hall will be renovated to maintain both the current size and functionality for its current activities, and to develop community welfare services around the social welfare council.

9. Disaster Preparedness Section

With disaster-related wireless resources from the fire department and others in place, this will function as the center of the City's disaster preparedness. The whole building will function as a disaster headquarters in times of disaster.

Important Procedures for Moving

1. Alien registration (new enrollment/changing address)

Type of notification	Notification period	Necessary documents
New enrollment (Mitaka City is your first address in Japan)	Within 90 days after entering Japan	Passport, two identical photos (two same photos, 4.5 cm x 3.5 cm, Not needed for under 16)
Changing registered address (Moving in from outside the city or moving within the city)	Within 14 days of moving to a new address	Certificate of Alien Registration

* When you move out of the city, please notify the local government of your new address within 14 days after moving.

Inquiries: Civil Affairs Section, Tel. 0422-45-1151 Ext. 2322

2. National Pension (new enrollment/changing address)

*Please apply after obtaining a Certificate of Alien Registration

Type of notification	Necessary documents
New enrollment (Mitaka City is your first address in Japan)	Certificate of Alien Registration
Changing registered address (Moving in from outside the city or moving within the city)	Certificate of Alien Registration, Pension Book

Inquiries: Civil Affairs Section, Tel. 0422-45-1151 Ext. 2395

3. Disposing of Bulky Garbage and Excessive Garbage (Domestic garbage only, reservations required)

Contact the "Bulky Garbage Reception Center" 1-2 weeks before moving.

*Guidelines for "excessive garbage"

Type of garbage	Quantity
Combustible/ Non-combustible garbage	More than four authorized garbage bags (40 liters) at a time
Other garbage	More than four bags (45 liters) at a time

* Excessive garbage disposal doesn't require the use of authorized garbage bags, however, please make sure to follow the city guidelines for separating garbage.

* Application and inquiries about the guidelines: Mitaka Bulky Garbage Reception Center, Tel. 03-5715-1212

Inquiries: Garbage Management Section, Tel. 0422-45-1151 Ext. 2534

4. National Health Insurance (enroll/change/withdraw)

Type of notification	Notification period	Necessary documents
Enroll (Moving in from outside the city)	Within 14 days of moving	Certificate of Alien Registration, Passport
Change/Withdraw (Moving in from outside the city or moving within the city)		Health Insurance Card

Inquiries: National Health Insurance Section, Tel. 0422-45-1151 Ext. 2383

5. Water Supply Connection and/or Stoppage

Beginning on April 1, the window for water bill payment will be moved from the Municipal Office to the Tokyo Metropolitan Government. Please be aware that payment will be no longer accepted at the Municipal Office or Municipal Office branches.

<Payment windows>

Chofu Service Station, Bureau of Waterworks, Tokyo Metropolitan Government (7-29-5 Kokuryo-cho, Chofu-shi)

<To start or stop water supply>

Contact the Bureau of Waterworks (Tokyo Metropolitan Government) Tama Customer Center, 3-4 days before moving into or out of a house/apartment. TEL. 0570-091-100 (From PHS or IP phone: 042-548-5100)

Hours: 8:30a.m.~8:00p.m. (except for Sundays and holidays)

Inquiries: Mitaka City Water Supply Section, Tel. 0422-45-1151 Ext. 3421

Spring Excursion "Ohanami - A Cherry-Viewing Picnic"

How about an outing for cherry blossom viewing with MISHOP friends? Experience Japan's spring season!

Date and Time: March 29 (Tue.), 11:00 a.m. ~ 2:00 p.m.

Venue: Jindai Botanical Garden and elsewhere

Meeting places: 1. MISHOP; 2. JR Mitaka Station Bus Terminal; 3. The main gate of Jindai Botanical Garden **Fee:** Please bring 200 yen (incl. admission to the garden) to the MISHOP office before March 28 (Mon.) *Fees are nonrefundable. **Eligibility:** Foreign residents or MISHOP members (families) **Bring your own:** Lunch and a picnic blanket; please wear walking shoes and comfortable picnic-clothing.

Application and inquiries: MISHOP office, call or via website. Tel. 0422-43-7812 **URL:** <http://www.mishop.jp/> (on a first-come-first-served basis)

*Please choose where you will meet the group (1 ~ 3 above) when you apply.

* Go or no-go decision will be made by 8:30 a.m. on the day in case of bad weather.



Population (As of February 1, 2011)

Population: 176,400 persons

The number of Foreign Registrants: 3,088 persons

Information Service for Foreign Residents

Time: Every 2nd Friday each month from 1:00 to 4:00 p.m. (the service counter is open until 3:00). Closed on National Holidays.

Place: Mitaka Municipal Office, 2F Consultation/Information Center

Tel: 0422-44-6600

Orientation about Elementary Schools for Foreign Residents

Orientation about municipal elementary schools will be held

For those parents who have children entering a municipal elementary school, an orientation about elementary schools will be held in multiple languages (English, Chinese, Korean).

We will talk about some rules that are good to know in school life and we'll help you fill in the forms which are necessary for entering schools.

Hosts: Mitaka City/Mitaka City Board of Education

Date: March 12 (Sat) 10 a.m. ~ 11 a.m.

Location: Mitaka City Education Center (Shimo-renjaku 9-11-7)

Application and inquiries: Call MISHOP before March 11 (Fri.)

Tel. 0422-43-7812

Let's Learn Everyday Dialogs! MISHOP Japanese Class

MISHOP is accepting students for a Japanese class. Let's study everyday dialogs, such as those about shopping and ordering food at a restaurant. We offer volunteer Japanese teachers and small classes! 25 useful situations based on daily life are chosen for the classes and each lesson will focus on one of the situations. You can join the class any time, even in the middle of the course. If you are interested in the classes, feel free to contact MISHOP.



<Japanese Classes>

Date: Every Saturday at 10 a.m. ~ 11:30 a.m.

Location: MISHOP

Lesson fees: 2,000 yen

Eligibility: Living, working or studying in Mitaka City

Texts: Created by MISHOP

Application and Inquiries: MISHOP office, call or via website.

Tel. 0422-43-7812 URL: <http://www.mishop.jp/>

Events of Mitaka City Arts Foundation

Ticket center Tel: 47-5122 Business hours 10:00 a.m. ~ 7:00 p.m.

The center is closed on March 7, 14, 22, 23, and 28.

[www http://mitaka-art.jp/ticket](http://mitaka-art.jp/ticket) (Japanese only)

 = A nursery service is available. (Please apply 2 weeks prior to each performance.)

Concert Hall "Kaze"

Mitaka Junior Orchestra (MJO) 9th Spring Concert

Date and Time: March 27 (Sun.), 2 p.m.

Tickets now on sale. All seats reserved.

Members 450 yen/ Nonmembers 500 yen/ Free admission for children 4 years of age or older through high school students.



* No children under the age of 4.

* No elementary school children or younger are allowed in the front row of the second floor or the balcony seats for safety.

Performers: Karl Naito, Daiki Shimizu, Masaki Ogawa (Conductor) MJO (Orchestra)

Program: St Paul's Suite (Holst), From Serenade No. 1 (Brahms) From "La Traviata", act one arranged for wind instruments (Verdi)

 MJO members will act as MCs for the Spring Concert again this year. Please enjoy their cheerful and sprightly performance, with the coming of spring.

外国人咨询

时间: 毎月第4金曜日
 下午一点至四点
 (打电话或亲自前来都可以)
 咨询预约至三点为止。
 地点: 咨询情报中心(市政府2楼)
 电话: 0422-44-6600

外国人相談窓口

英語: 毎月第2金曜日
 中国語: 毎月第4金曜日
 時間: いずれも祝日を除く午後1時~4時
 (受付は3時まで)
 場所: 市役所2階相談・情報センター
 電話: 0422-44-6600



Information

Information about Mitaka International Society for HOspitality

MISHOP Office

Days: Monday through Saturday (Closed on Sundays and national holidays)

Hours: 9:30 a.m. to 5:15 p.m.

Location: Mitaka City Chuo-Dori Town Plaza 4F, 3-30-12, Shimorenjaku

Tel: 0422-43-7812 **Fax:** 0422-43-9966

E-mail: mishop@parkcity.ne.jp

URL: <http://www.mishop.jp>

Established: November 23, 1989

